

vtech[®]

Instruction Manual

Let's Go Rescue Pup[™]



INTRODUCTION

Thank you for purchasing the **Let's Go Rescue Pup™**.

I'm adopted and I'm a good puppy! I will be very happy when you feed me, give me water, pat my head and take me for a walk. Learn about colors and numbers with me and hear me sing!

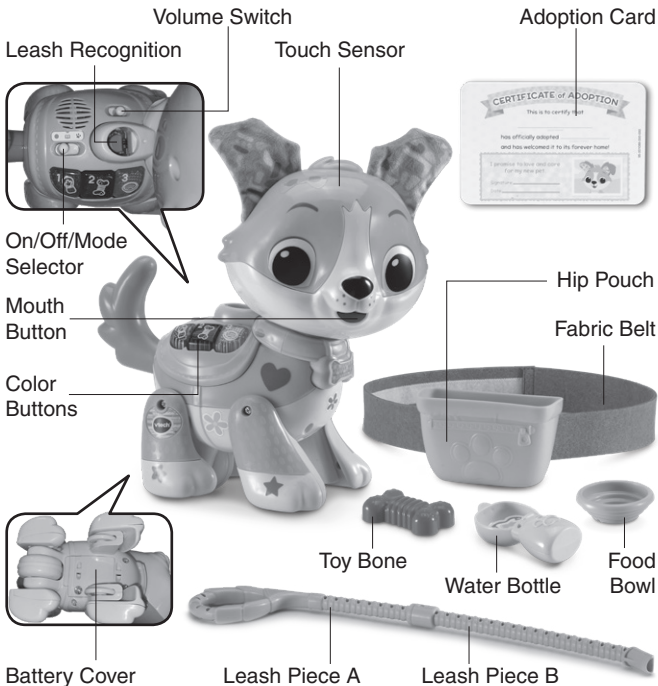

INCLUDED IN THE PACKAGE

- Let's Go Rescue Pup™



- 1 Hip Pouch
- 1 Fabric Belt



- 1 Adoption Card



- Quick Start Guide

- Leash Piece A
- Leash Piece B

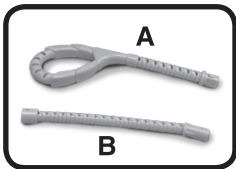

- 1 Toy Bone
- 1 Food Bowl
- 1 Water Bottle



- 1 Sticker Sheet



WARNING

All packing materials such as tape, plastic sheets, packaging locks, removable tags, cable ties, cords and packaging screws are not part of this toy, and should be discarded for your child's safety.

NOTE

Please save this Instruction Manual as it contains important information.

ATTENTION

Pour la sécurité de votre enfant, débarrassez-vous de tous les produits d'emballage tels que rubans adhésifs, feuilles de plastique, attaches, étiquettes, cordons et vis d'emballage. Ils ne font pas partie du jouet.

NOTE

Il est conseillé de sauvegarder ce manuel d'instructions car il comporte des informations importantes.

ASSEMBLY INSTRUCTIONS

With the **Let's Go Rescue Pup™**, safety comes first. Adult assembly required. For your child's safety, do not let them play with this toy until it is fully assembled.

Leash Assembly

1. Insert the end of **Leash Piece A** into the top of **Leash Piece B**.
2. Insert the end of **Leash Piece B** into the **Leash Recognition** on the collar.
3. Hold the **Leash** and push the puppy along to play.

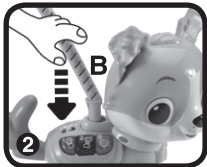
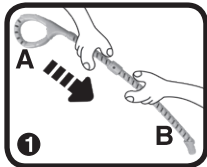

Hip Pouch and Belt Assembly

1. Identify the inner portion of the **Fabric Belt** by locating the long section of the hook-and-loop closure.
2. With the inner portion of the belt facing the back of the **Hip Pouch** where the two slots are, place the **Fabric Belt** ends through the **Hip Pouch** slots from the inside of the pouch.
3. The seams will hold the **Fabric Belt** in place from the inside of the **Hip Pouch**.
4. Put the **Fabric Belt** around the child's waist and secure with the hook-and-loop closure.



GETTING STARTED

Battery Removal and Installation

1. Make sure the unit is turned **Off**.
2. Find the battery cover located on the bottom of the unit, use a screwdriver to loosen the screw and then open the battery cover.
3. Remove old batteries by pulling up on one end of each battery.

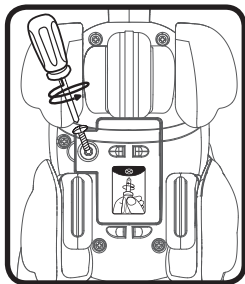

4. Install 2 new AA (AM-3/LR6) batteries following the diagram inside the battery box. (For best performance, alkaline batteries or fully charged Ni-MH rechargeable batteries are recommended.)
5. Replace the battery cover and tighten the screw to secure.

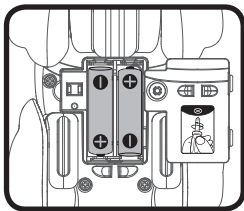

WARNING:

Adult assembly required for battery installation.
Keep batteries out of reach of children.



ATTENTION :

Les piles ou accumulateurs doivent être installés par un adulte.
Tenir les piles ou accumulateurs hors de portée des enfants.

IMPORTANT: BATTERY INFORMATION

- Insert batteries with the correct polarity (+ and -).
- Do not mix old and new batteries.
- Do not mix alkaline, standard (carbon-zinc) or rechargeable batteries.
- Only batteries of the same or equivalent type as recommended are to be used.
- Do not short-circuit the supply terminals.
- Remove batteries during long periods of non-use.
- Remove exhausted batteries from the toy.
- Dispose of batteries safely. Do not dispose of batteries in fire.

RECHARGEABLE BATTERIES

- Remove rechargeable batteries from the toy before charging.
- Rechargeable batteries are only to be charged under adult supervision.
- Do not charge non-rechargeable batteries.

PERSONALIZE YOUR PUPPY

Congratulations on your puppy adoption! Stickers are provided to style your puppy any way you want. Please securely stick the labels to any smooth surface on the toy.

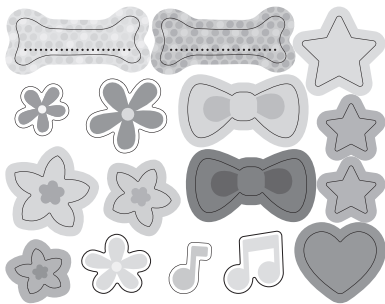

Fill out the included **Adoption Card** and keep it in a safe place. Write your puppy's name on the included bone-shaped sticker and stick it on the puppy's collar. Two dog tag stickers are provided.

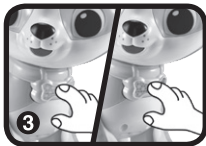
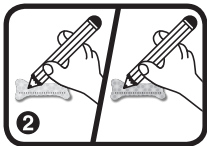

ACTIVATE NORMAL PLAY MODE

This product is in Try-Me mode in the packaging. When you play with the **Let's Go Rescue Pup™** for the first time, slide the **On/Off/Mode Selector** to Learning mode or Role-Play mode, and insert the **Leash** into the collar. You will hear three beeps to confirm that you have exited Try-Me mode.

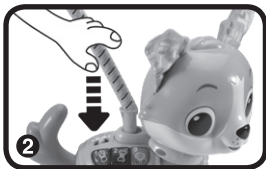

PRODUCT FEATURES

1. On/Off/Mode Selector

To turn the unit **On**, slide the selector from **Off** to Learning mode or Role-Play mode. To turn the unit **Off**, slide the Selector to the **Off** position.



2. Volume Switch

To adjust the volume, slide the switch between the Low or High volume position.



3. Touch Sensor

Pat the puppy's head to hear fun responses and play games.



4. Push-Along Play

Push the puppy along for a walk to hear cute responses, melodies or sing-along songs. When the puppy is pushed faster, the melodies play faster. The puppy loves to walk with the **Leash**. Attach the **Leash** to his collar and go!



5. Color Buttons

Let's learn colors and numbers with the puppy. Press the **Color Buttons** to learn about the colors yellow, red and green, and the numbers 1, 2 and 3.



6. Water Bottle

Insert the **Water Bottle** into the puppy's **Mouth** when he is thirsty. He feels better now!



7. Automatic Shut-Off

To preserve battery life, **Let's Go Rescue Pup™** will shut off automatically after several minutes without input. The unit can be turned on again by sliding the **On/Off/Mode Selector**, or by pressing any of the **Color Buttons**.

NOTE: The **Red Button** will flash several times and power down when the unit's battery level is low. If the unit powers down or if the light fades out during play, please install a new set of batteries.

ACTIVITIES

1. Learning Mode

Press the **Color Buttons** to learn about colors, numbers, and the puppy's accessories. Pat the puppy's head for cute responses. Push the puppy along to hear sounds, melodies and songs.

2. Role-Play Mode

Interact with the puppy in ten different role-play scenarios. He will ask you to take him for a walk, pat his head, give him water and more. The puppy also likes color and number games. Play with the puppy to keep him healthy and happy.

SONG LYRICS

Song 1

For I'm a jolly good doggo,
For I'm a jolly good doggo,
For I'm a jolly good doggo,
Which nobody can deny.
Which nobody can deny.

Song 2

I am a happy dog, a friendly dog,
A dog who loves to walk.
Walk and talk and walk and sniff.
Love to sniff each and every whiff!

Song 3

Let's go for a W-A-L-K, that's walk, walk, walk.
If I got my leash on and my best pal,
Let's go for a walky, walky, walk, walk, walk.

Song 4

Walking slowly, walking slowly,
Gives you time, gives you time.
To stop and smell the flowers,
Feel the sun or showers,
Sniff a lot, sniff a lot.

Song 5

Walking quickly, walking quickly,
Saves you time, saves you time.
Gets you where you're going,
Feel the wind a blowing,
Through your hair, through your hair.
Walking quickly, walking quickly,
Saves you time, saves you time.
Gets you where you're going,
Feel the wind a blowing,
Through your hair, through your hair!

CARE & MAINTENANCE

1. Keep the unit clean by wiping it with a slightly damp cloth.
2. Keep the unit out of direct sunlight and away from any direct heat sources.
3. Remove the batteries if the unit will not be in use for an extended period of time.
4. Do not drop the unit on hard surfaces and do not expose the unit to moisture or water.
5. Do not manually force the puppy's head and legs to move.

TROUBLESHOOTING

If for some reason the unit stops working or malfunctions, please follow these steps:

1. Turn the unit **Off**.
2. Interrupt the power supply by removing the batteries.
3. Let the unit stand for a few minutes, then replace the batteries.
4. Turn the unit **On**. The unit should now be ready to use again.
5. If the unit still does not work, install a new set of batteries.

IMPORTANT NOTE:

If the problem persists, please call our **Consumer Services Department** at **1-800-521-2010** in the U.S. or **1-877-352-8697** in Canada, or by going to our website at **vtechkids.com** and filling out our **Contact Us** form located under the **Customer Support** link. Creating and developing **VTech®** products is accompanied by a responsibility that we take very seriously. We make every effort to ensure the accuracy of the information, which forms the value of our products. However, errors sometimes can occur. It is important for you to know that we stand behind our products and encourage you to contact us with any problems and/or suggestions that you might have. A service representative will be happy to help you.

NOTE

This equipment has been tested and found to comply with the limits for a Class B digital device, pursuant to Part 15 of the FCC Rules. These limits are designed to provide reasonable protection against harmful interference in a residential installation. This equipment generates, uses and can radiate radio frequency energy and, if not installed and used in accordance with the instructions, may cause harmful interference to radio communications. However, there is no guarantee that interference will not occur in a particular installation. If this equipment does cause harmful interference to radio or television reception, which can be determined by turning the equipment off and on, the user is encouraged to try to correct the interference by one or more of the following measures:

- Reorient or relocate the receiving antenna.
- Increase the separation between the equipment and receiver.
- Connect the equipment into an outlet on a circuit different from that to which the receiver is connected.
- Consult the dealer or an experienced radio/TV technician for help.

CAUTION

Changes or modifications not expressly approved by the party responsible for compliance could void the user's authority to operate the equipment.

Supplier's Declaration of Conformity 47 CFR § 2.1077 Compliance Information

Trade Name: VTech®
Model: 5525
Product Name: Let's Go Rescue Pup™
Responsible Party: VTech Electronics North America, L.L.C.
Address: 1156 W. Shure Drive, Suite 200
Arlington Heights, IL 60004
Website: vtechkids.com

THIS DEVICE COMPLIES WITH PART 15 OF THE FCC RULES. OPERATION IS SUBJECT TO THE FOLLOWING TWO CONDITIONS: (1) THIS DEVICE MAY NOT CAUSE HARMFUL INTERFERENCE, AND (2) THIS DEVICE MUST ACCEPT ANY INTERFERENCE RECEIVED, INCLUDING INTERFERENCE THAT MAY CAUSE UNDESIRE OPERATION.

CAN ICES-003(B)/NMB-003(B)

**Visit our website for more
information about our products,
downloads, resources and more.**

vtechkids.com
vtechkids.ca

Read our complete warranty policy online at
vtechkids.com/warranty
vtechkids.ca/warranty

